

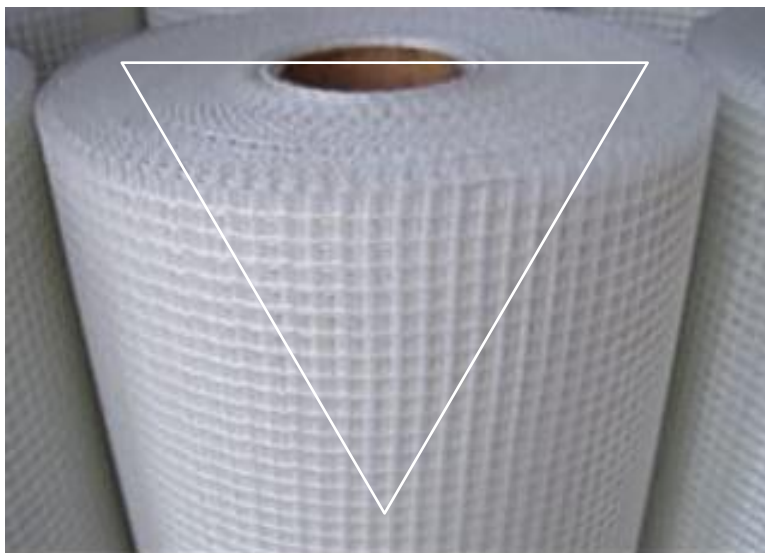

VPI MESH 4 • REINFORCING MESH



PRODUCT DESCRIPTION

Alkali resistant reinforcing mesh for use with cement/lime and polymer modified render systems to provide enhanced crack resistance to render systems onto masonry substrates. The mesh should be used in conjunction with the appropriate VPI products and systems including RHEATHERM 600 & 600 LR EWI systems.

SUBSTRATES

Masonry and walls conforming to BS 5628-3 and constructed from the following:

- Brickwork & Stonework
- Lightweight, & Dense Aggregate Blockwork
- Clay/Clinker Blocks – PoroTherm, Concrete
- Aircrete/Aerated light-weight Blocks
- Well bonded existing un-painted render

VPI Specified Systems:

- VPI - Specified Base Coats
- RheaTherm 600
- RheaTherm 600 LR
- Painted Substrates (using RenoPass Inter)

SUPPORTING PRODUCTS

- MONOCAL GRIS GF
- TRADIBATARD GF
- RENOPASS INTER - Painted Substrates
- RHEAMIX MONO,
- RHEAJET
- VPI MESH

PRODUCT APPLICATION

(Ensure the guidance for mixing including water settings/proportions are followed for complementary products)

- VPI MESH 4 is designed to be embedded into supporting products listed above to provide enhanced crack resistance of the render system.
- See below application details.

APPLICATION CONDITIONS

- Temperature: +5°C +30°C.
- Do not apply in wet weather
- Do not apply if there is a risk of Frost or Freezing Conditions

SUBSTRATE PREPARATION

Please contact VPI UK Ltd for specific application procedures

- Substrate must be clean, dry, dust free: e.g: formwork oil, curing agent...
- Construction should conform to the substrate requirements found within VPI Specification.
- Remove excess render/plaster, mould/release oil, paint and masonry coatings.

TECHNICAL CHARACTERISTICS

APPEARANCE: White with Blue Logo

COMPOSITION: Alkali Resistant Glass Fibre

Information provided in this document is based on our knowledge and experience of the products supplied, application results can vary depending on the application methods and skill of the installer of the products. Before application of the products in the information sheet it is recommended to check if this is the most current and up to date version of the document.



VPI MESH 4 • REINFORCING MESH

PRECAUTIONS FOR USE

To protect your health and the environment, and for safe use of this product, follow the precautionary statements which are labelled on the packaging. You will find the safety instructions for this product in the Safety Data Sheet.

PRODUCT COVERAGE:

- 1m x 50m Roll = 50m²

PACKAGING:

- 30 Rolls per pallet - Shrink wrapped and labelled.

STORAGE:

Store vertically in a cool dry, environment without contact with the ground at a consistent temperature.

HEALTH & SAFETY:

Suitable protective clothing required when handling and using this product. The product contains materials which can cause an allergic reaction, irritation to eyes and harmful consumed. Seek medical advice in case of contact with eyes. Keep out of the reach of children and minors.

Always read and follow the guidance set out in the Health and Safety data sheet for this product.

APPROVALS:

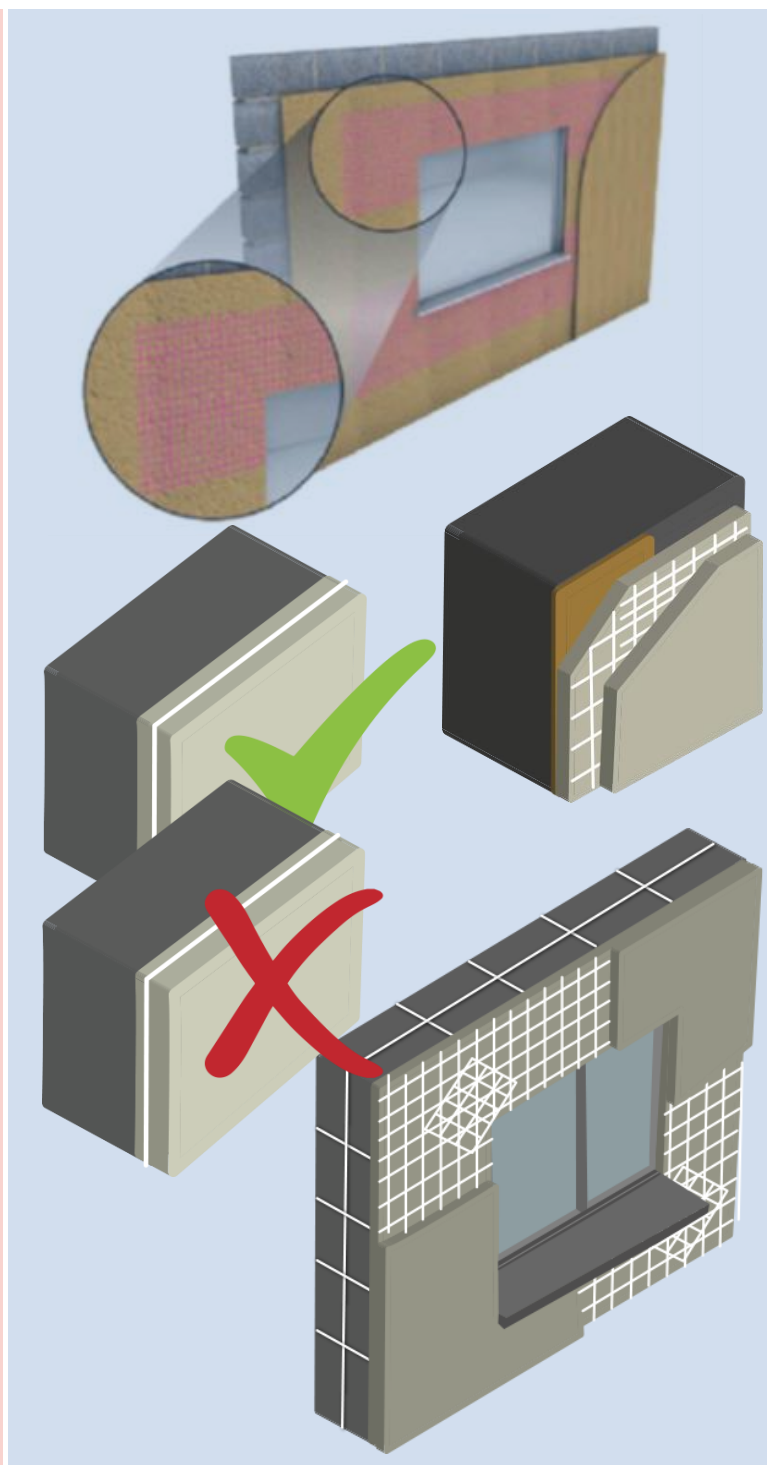
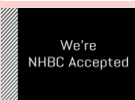

Information provided in this document is based on our knowledge and experience of the products supplied, application results can vary depending on the application methods and skill of the installer of the products. Before application of the products in the information sheet it is recommended to check if this is the most current and up to date version of the document.